

ASSEMBLY INSTRUCTIONS

TEPEE MOBILE SCREEN

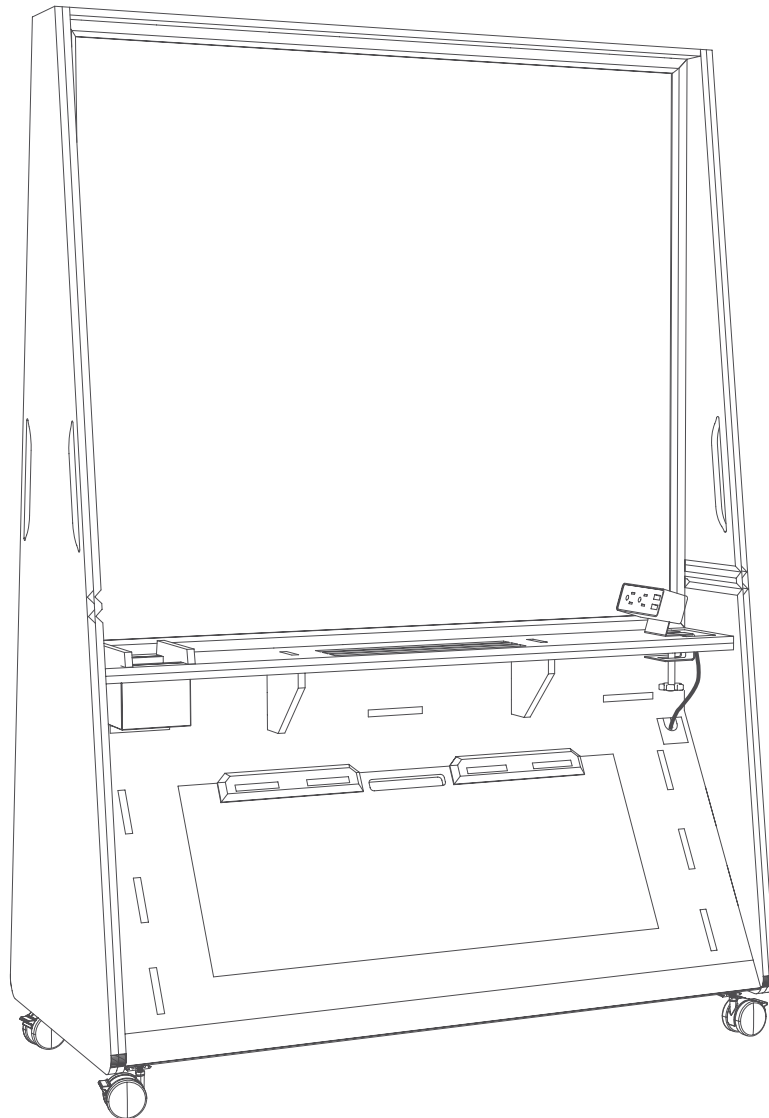

*Images reflect typical hardware options. Please refer to packing list for items & quantities specific to your order

Thank you for your order!

For questions or concerns regarding your order or installation, please contact customer service via email at customercare@ezobord.co.uk, or call us at 01843 666111 (International +44 1843 666111).

Visit our website at shop.ezobord.com/uk

ASSEMBLY INSTRUCTIONS

TEPEE MOBILE SCREEN

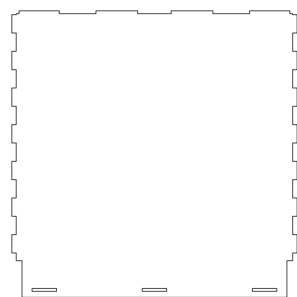

A1 - MAIN PANEL

X1

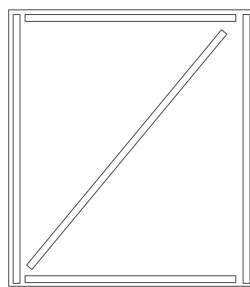

W1 - WHITE BOARD

X1

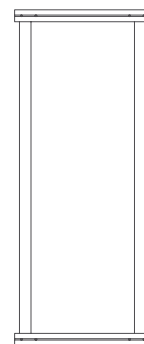

H2 - CASTER FRAME

X1

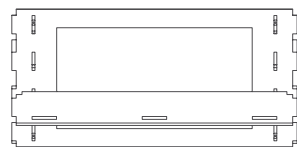

A2 - BASE FRAME

X1

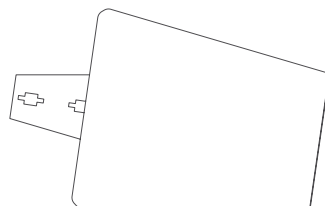

B1 - OUTER SIDE PANEL

X2

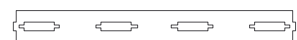

B3 - TOP EDGE FRAME

X1

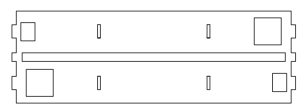

A3 - SHELF TOP

X1

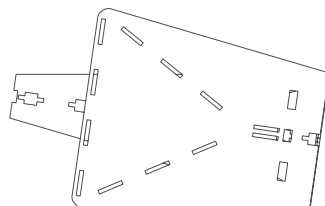

B2 - INNER SIDE PANEL

X2

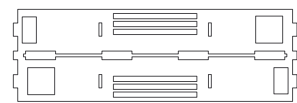

A4 - SHELF BOTTOM

X1



A5 - TRIM SET (4PCS)

X2



A6 - BASE SUPPORT

X2

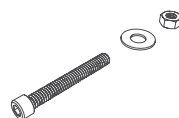

H1 - SET OF BOLT/
WASHER/NUT

X4



A7 - CABLE COVER

X2



A8 - ACCESORY CAP

X2



A9 - DOOR FLAP TAB

X4



A10 - SHELF SUPPORT

X3

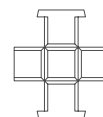

A11 - CUP HOLDER

X2



H3 - CASTER

X4



H4 - POWER MODULE

X2



A12 - LOCKING KEYS

X3



A13 - TAB LOCKING KEYS

X8

*Images reflect typical hardware options. Please refer to packing list for items & quantities specific to your order

Thank you for your order!

For questions or concerns regarding your order or installation, please contact customer service via email at customercare@ezobord.co.uk, or call us at 01843 666111 (International +44 1843 666111).

Visit our website at shop.ezobord.com/uk

ASSEMBLY INSTRUCTIONS

TEPEE MOBILE SCREEN

- 1** Unfold the BASE FRAME (A2).

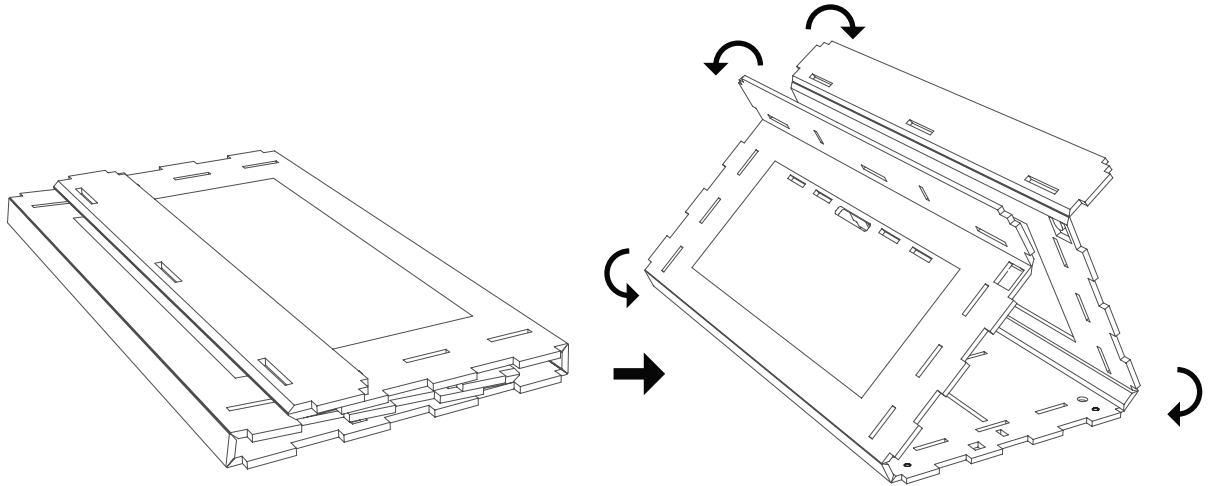

- 2** Fasten the CASTER FRAME (H2) to the BASE FRAME (A2) with BOLT SETS (H1).
(* hand drill not provided).

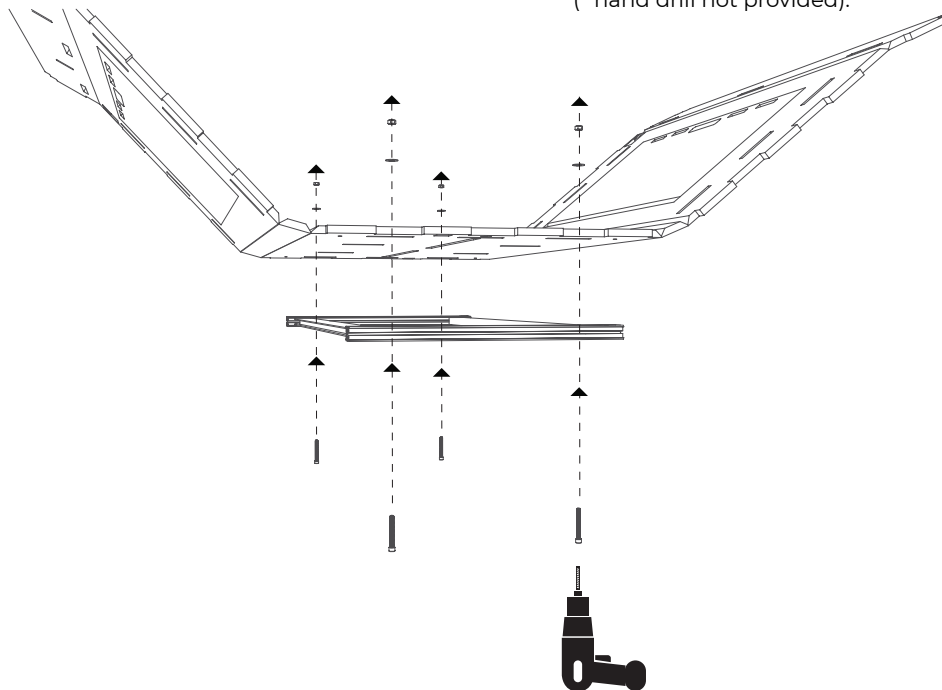

Thank you for your order!

For questions or concerns regarding your order or installation, please contact customer service via email at customercare@ezobord.co.uk, or call us at 01843 666111 (International +44 1843 666111).

Visit our website at shop.ezobord.com/uk

ASSEMBLY INSTRUCTIONS

TEPEE MOBILE SCREEN

- 3** Use a wrench to tighten the CASTERS (H3) to the CASTER FRAME (H2). (*wrench not provided)

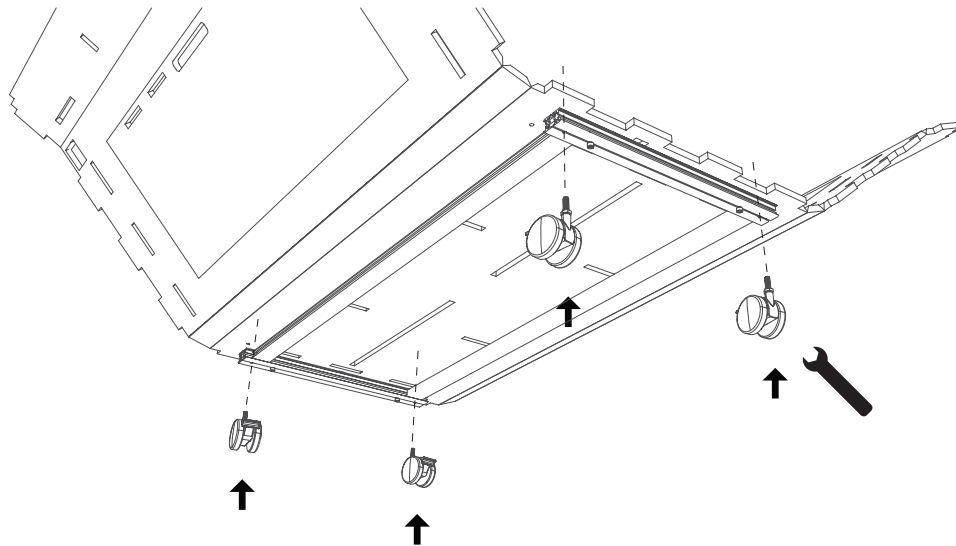

- 4** Insert the BASE SUPPORT (A6) into each end of the BASE FRAME (A2), to complete the BASE SUBASSEMBLY.

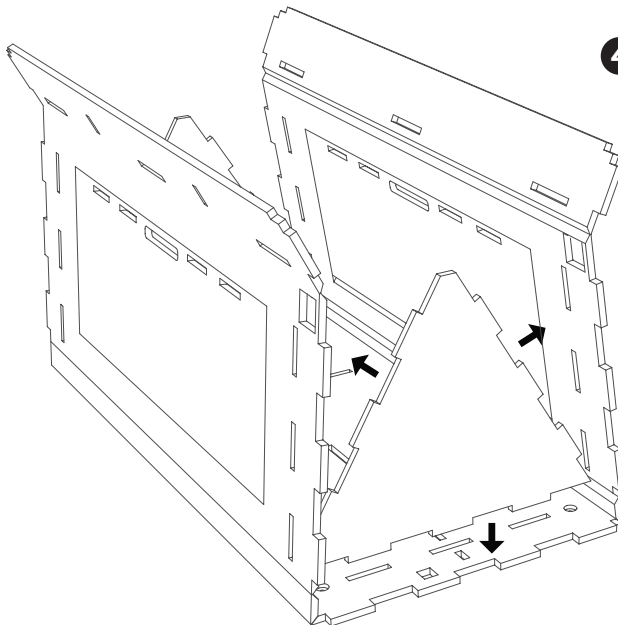

Thank you for your order!

For questions or concerns regarding your order or installation, please contact customer service via email at customercare@ezobord.co.uk, or call us at 01843 666111 (International +44 1843 666111).

Visit our website at shop.ezobord.com/uk

ASSEMBLY INSTRUCTIONS

TEPEE MOBILE SCREEN

5

Slide the MAIN PANEL (A1) into the slots in the center of the SHELF TOP (A3) and the SHELF BOTTOM (A4), then insert the remainder of the main panel between the two halves of the BASE FRAME (A2).

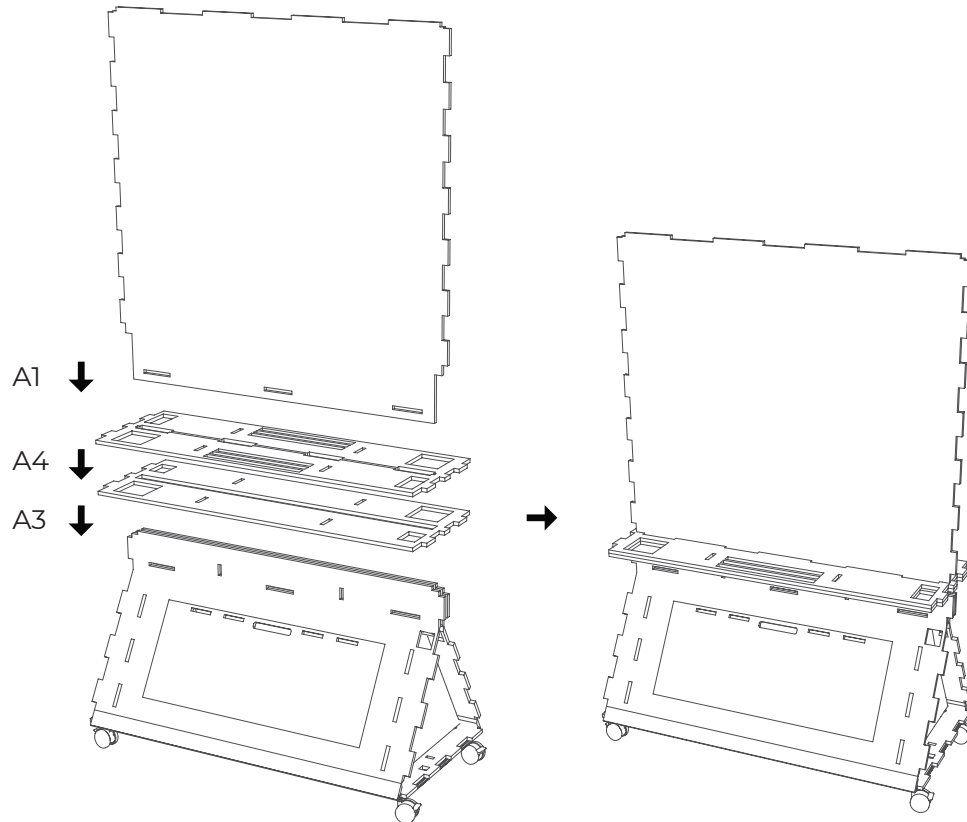

6

Insert the LOCKING KEYS (A12) into the aligned slots of the BASE SUBASSEMBLY.

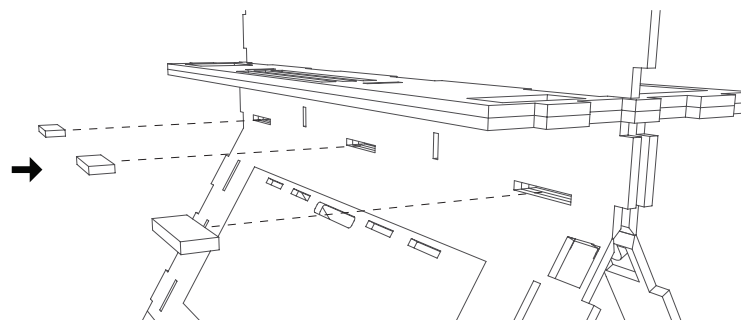

Thank you for your order!

For questions or concerns regarding your order or installation, please contact customer service via email at customercare@ezobord.co.uk, or call us at 01843 666111 (International +44 1843 666111).

Visit our website at shop.ezobord.com/uk

ASSEMBLY INSTRUCTIONS

TEPEE MOBILE SCREEN

- 7** Unfold the OUTER SIDE PANELS (B1) and the INNER SIDE PANELS (B2).

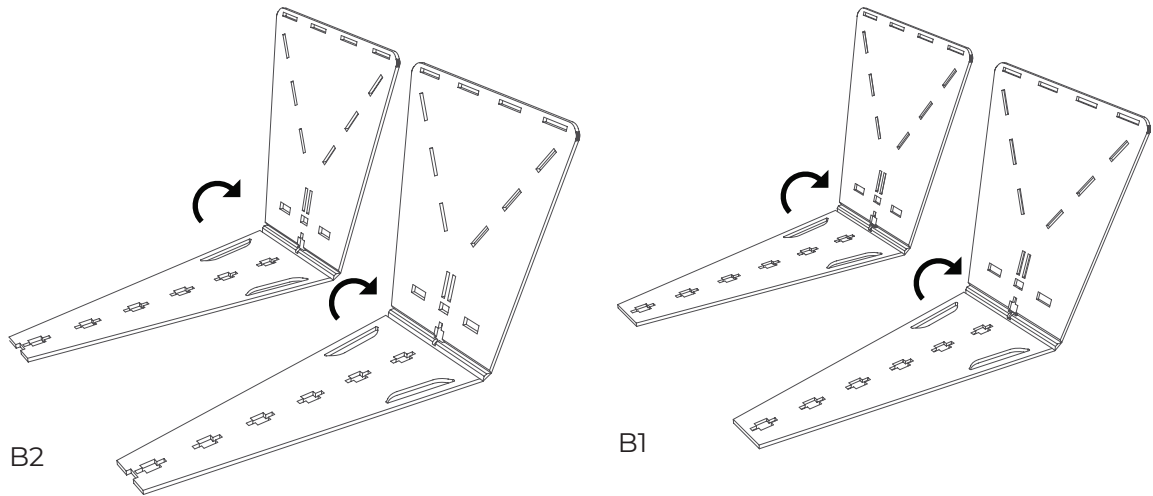

- 8** Insert the tabs on the main structure into the corresponding holes on the INNER SIDE PANELS (B1) and the OUTER SIDE PANELS (B2).

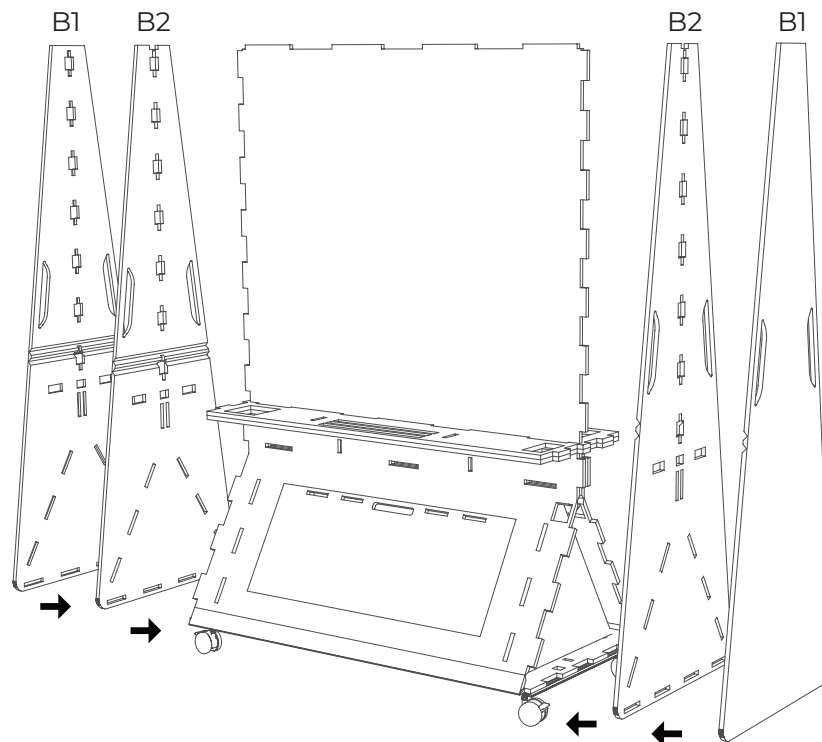

Thank you for your order!

For questions or concerns regarding your order or installation, please contact customer service via email at customercare@ezobord.co.uk, or call us at 01843 666111 (International +44 1843 666111).

Visit our website at shop.ezobord.com/uk

ASSEMBLY INSTRUCTIONS

TEPEE MOBILE SCREEN

- 9** Press the TOP EDGE FRAME (B3) onto the tabs of the MAIN PANEL (A1) on the top. Insert the end tabs of the TOP EDGE FRAME (B3) into the notch of the INNER SIDE PANEL (B2).

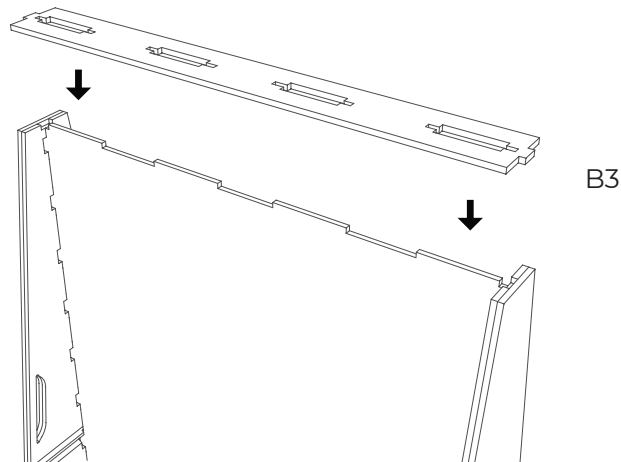

- 10** Insert the SUPPORTING BRACKETS (A10) into the slots beneath the SHELF on either side of the mobile screen.

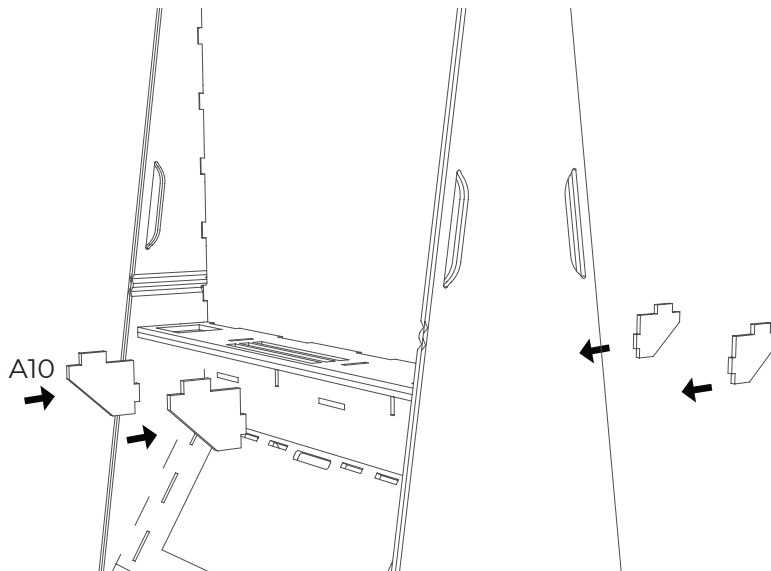

Thank you for your order!

For questions or concerns regarding your order or installation, please contact customer service via email at customercare@ezobord.co.uk, or call us at 01843 666111 (International +44 1843 666111).

Visit our website at shop.ezobord.com/uk

ASSEMBLY INSTRUCTIONS

TEPEE MOBILE SCREEN

- 11** Peel the cover off the tape on the WHITE BOARD (W1).

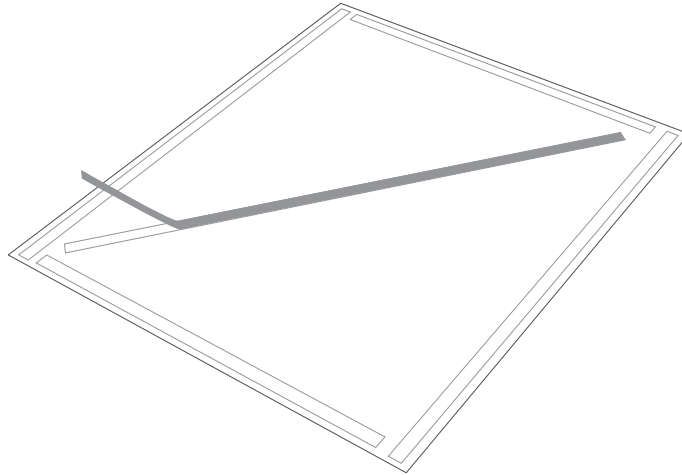

- 12** Carefully apply the WHITE BOARD (W1) to the center of the MAIN PANEL (A1).

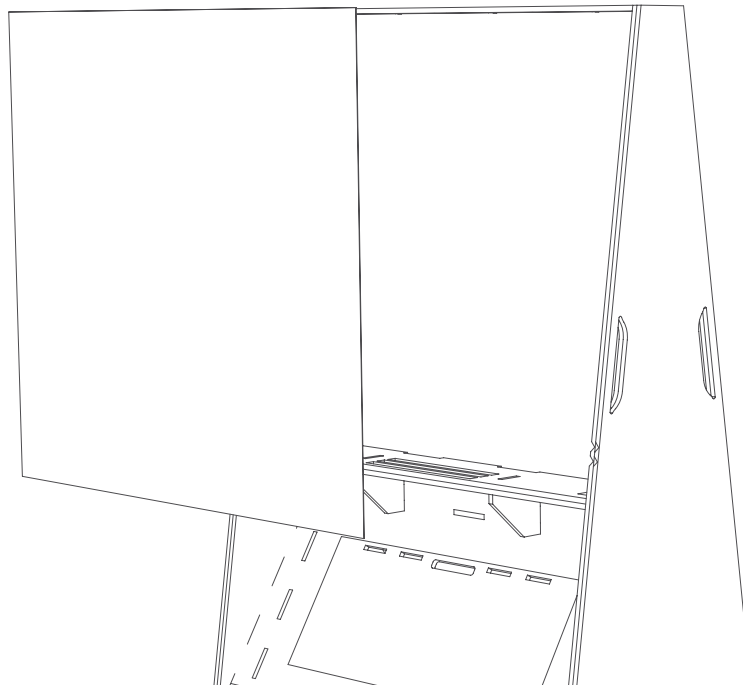

Thank you for your order!

For questions or concerns regarding your order or installation, please contact customer service via email at customercare@ezobord.co.uk, or call us at 01843 666111 (International +44 1843 666111).

Visit our website at shop.ezobord.com/uk

ASSEMBLY INSTRUCTIONS

TEPEE MOBILE SCREEN

- 13** Cover the edge of the WHITE BOARD (W1) with the TRIM SET (A5), inserting the tabs of the TRIM SET into the slots around the the WHITE BOARD (W1) on the SIDE PANELS.

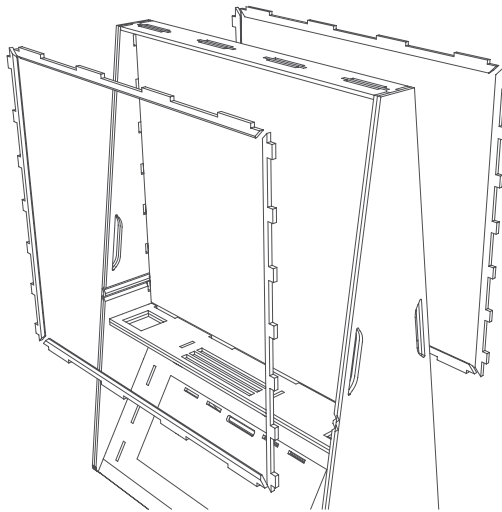

- 14** Fold up the 4 sides of the CUP HOLDER (A11), and insert it into the square cavity of the SHELF.

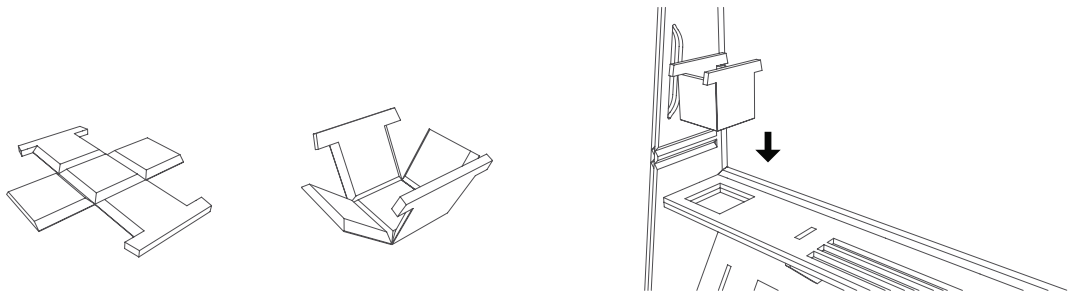

Thank you for your order!

For questions or concerns regarding your order or installation, please contact customer service via email at customercare@ezobord.co.uk, or call us at 01843 666111 (International +44 1843 666111).

Visit our website at shop.ezobord.com/uk

ASSEMBLY INSTRUCTIONS

TEPEE MOBILE SCREEN

- 15** Install the POWER MODULE (H4) into the rectangular hole in the SHELF, and use the ACCESSORY CAP (A8) to fill the remaining hole.

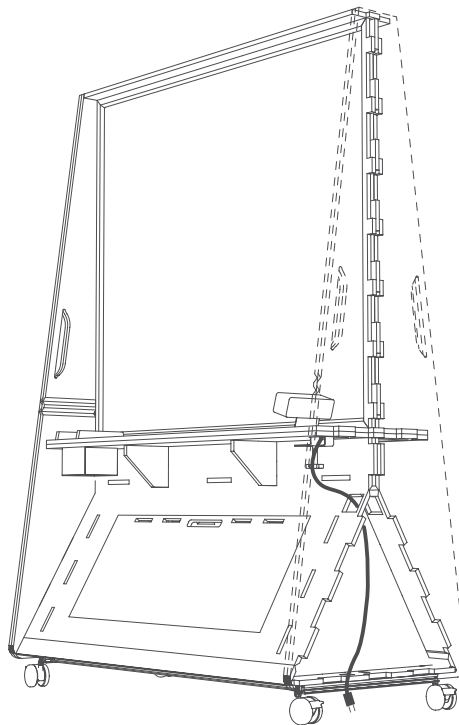
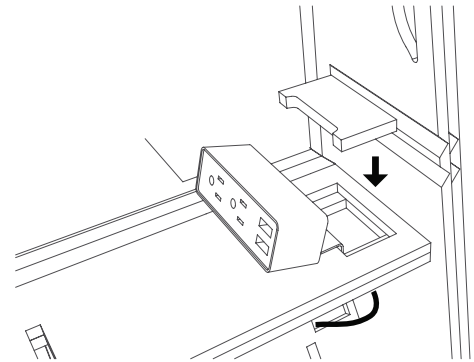
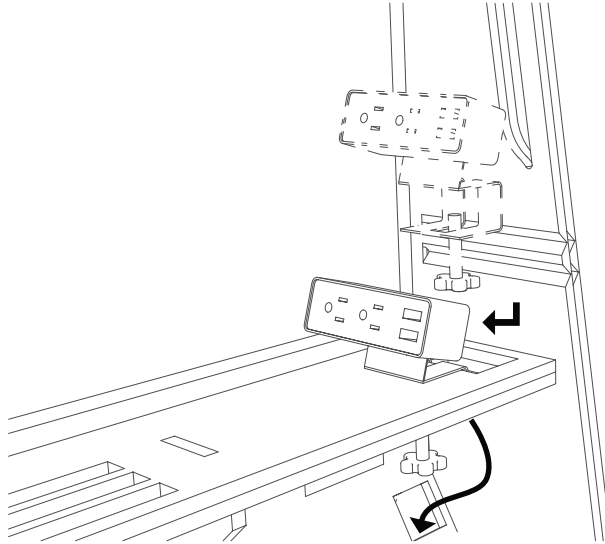

- 16** Run the cable of the POWER MODULE (H4) through the hole on the front of the BASE and behind the SIDE PANELS.

Thank you for your order!

For questions or concerns regarding your order or installation, please contact customer service via email at customercare@ezobord.co.uk, or call us at 01843 666111 (International +44 1843 666111).

Visit our website at shop.ezobord.com/uk

ASSEMBLY INSTRUCTIONS

TEPEE MOBILE SCREEN

- 17** Insert the TAB LOCKING KEYS (A13) through the aligned slots in the DOOR FLAP TABs (A9) and door flap on the BASE FRAME (A2).

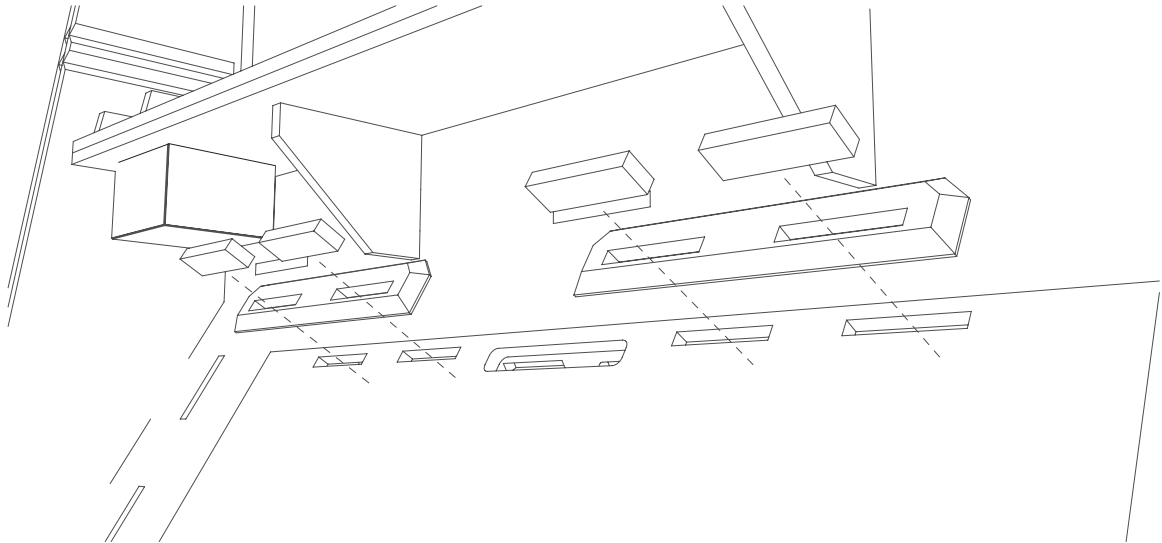

Thank you for your order!

For questions or concerns regarding your order or installation, please contact customer service via email at customercare@ezobord.co.uk, or call us at 01843 666111 (International +44 1843 666111).

Visit our website at shop.ezobord.com/uk