

ASSEMBLY INSTRUCTIONS

# BAFFLE CLOUD

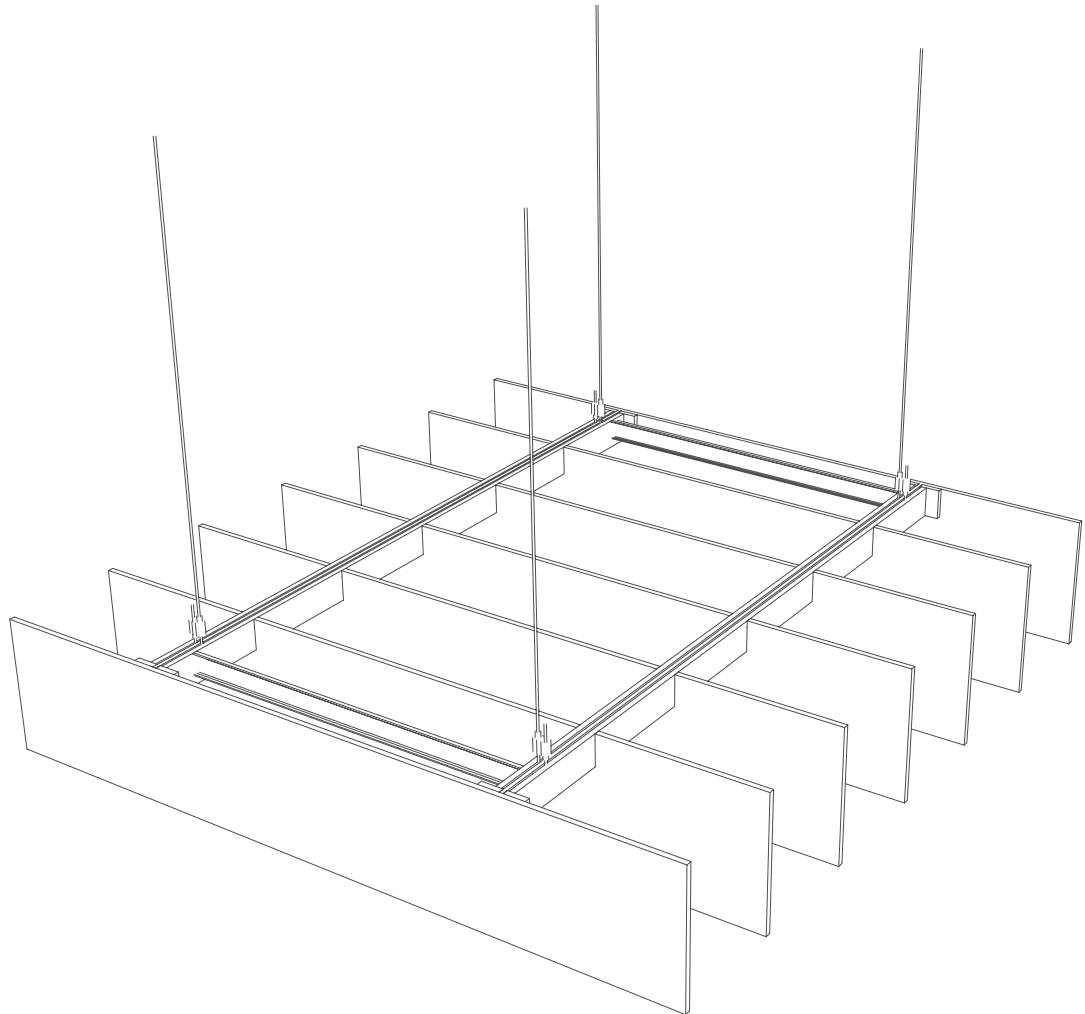

**\* BAFFLE CLOUD INSTALLATION GUIDE APPLIES TO ALL BAFFLE CLOUDS .**

\*Images reflect typical hardware options. Please refer to packing list for items & quantities specific to your order

**Thank you for your order!**

For questions or concerns regarding your order or installation, please contact customer service via email at [customercare@ezobord.co.uk](mailto:customercare@ezobord.co.uk), or call us at 01843 666111 (International +44 1843 666111).

Visit our website at [shop.ezobord.com/uk](http://shop.ezobord.com/uk)

## ASSEMBLY INSTRUCTIONS

# BAFFLE CLOUD

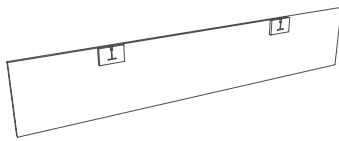

END BAFFLE **X2**

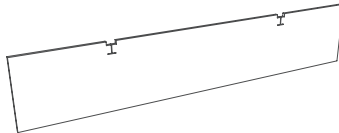

REGULAR BAFFLE **X2**

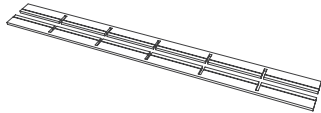

SPACER TRIM SET **X2**

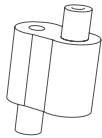

LOOPING CABLE GRIPPER  
CG7250 **X2**



UPPER SUSPENSION HOUSING  
CF6-01 **X2**

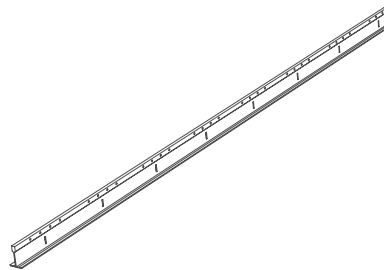

MAIN TBAR **X2**



CROSS TBAR **X2**

**Thank you for your order!**

For questions or concerns regarding your order or installation, please contact customer service via email at [customercare@ezobord.co.uk](mailto:customercare@ezobord.co.uk), or call us at 01843 666111 (International +44 1843 666111).

Visit our website at [shop.ezobord.com/uk](http://shop.ezobord.com/uk)

ASSEMBLY INSTRUCTIONS

# BAFFLE CLOUD

- 1 Screw the CF6-01 UPPER SUSPENSION HOUSING to the ceiling  
(\*Screws, hand drill not included.)

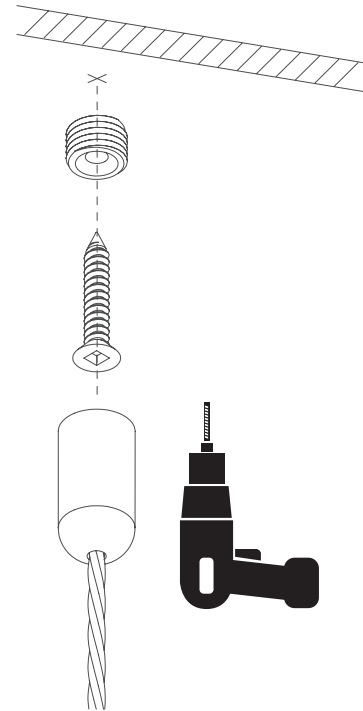

- 2 Assemble the TBAR GRID.

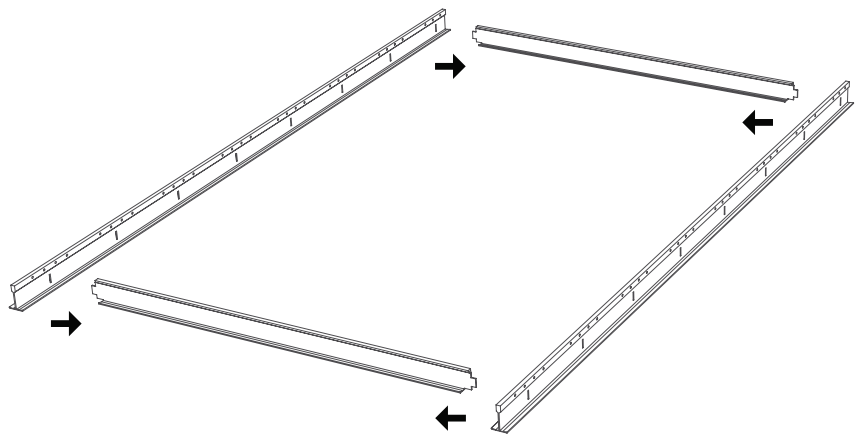

**Thank you for your order!**

For questions or concerns regarding your order or installation, please contact customer service via email at [customercare@ezobord.co.uk](mailto:customercare@ezobord.co.uk), or call us at 01843 666111 (International +44 1843 666111).

Visit our website at [shop.ezobord.com/uk](http://shop.ezobord.com/uk)

## ASSEMBLY INSTRUCTIONS

# BAFFLE CLOUD

- 3** Loop the cable of CF6-01 through the holes on the TBAR GRID with the CG7250 LOOPING CABLE GRIPPER.

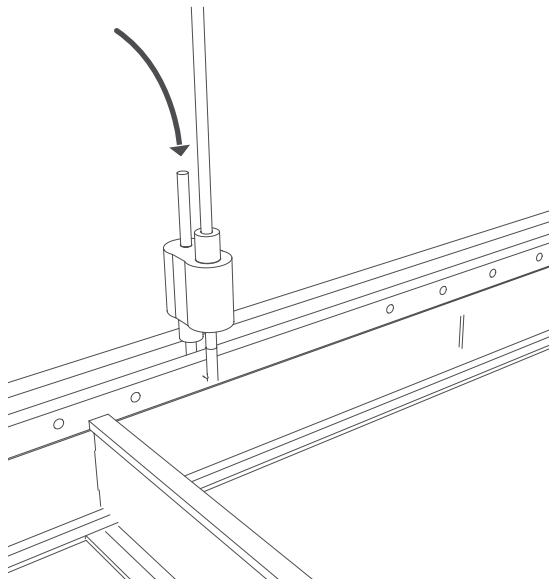
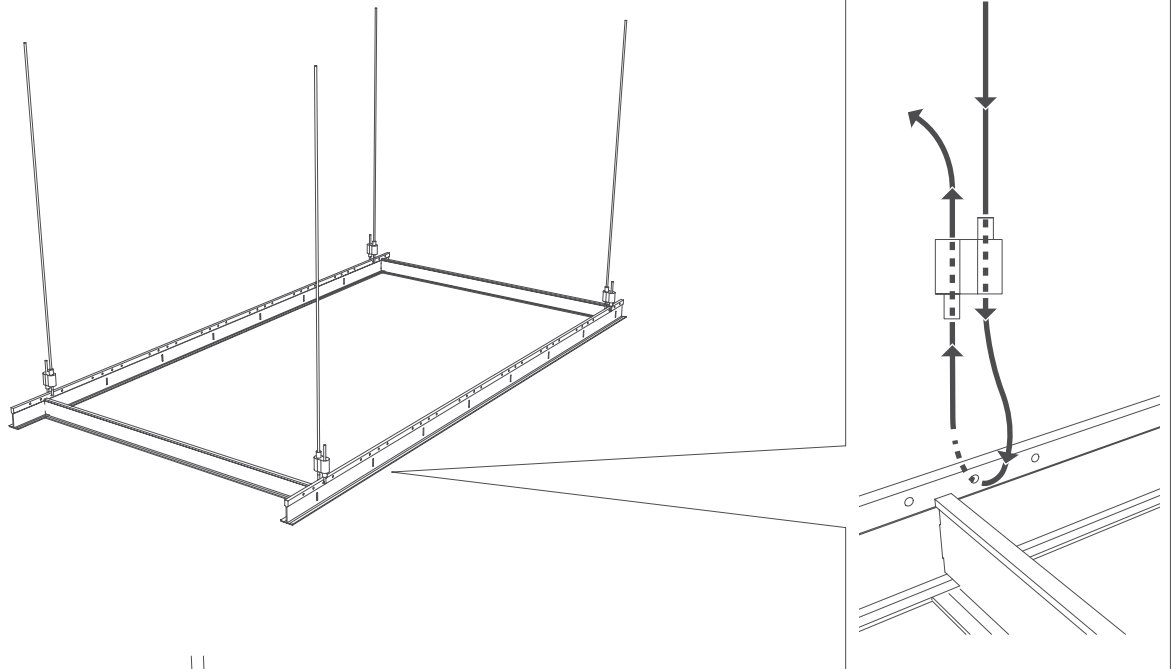

- 4** Adjust the cables to level TBAR GRID by pulling the cable coming out of the CG7250 LOOPING CABLE GRIPPER.

**Thank you for your order!**

For questions or concerns regarding your order or installation, please contact customer service via email at [customercare@ezobord.co.uk](mailto:customercare@ezobord.co.uk), or call us at 01843 666111 (International +44 1843 666111). Visit our website at [shop.ezobord.com/uk](http://shop.ezobord.com/uk)

ASSEMBLY INSTRUCTIONS

# BAFFLE CLOUD

- 5** Twist open the TBAR cut out on the BAFFLE and then push the .

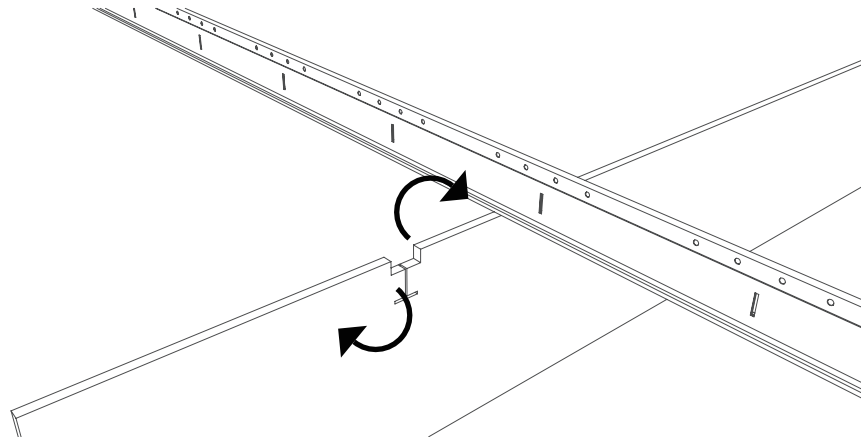

- 6** Adjust the cables to level TBAR GRID by pulling the cable coming out of the CG7250 LOOPING CABLE GRIPPER.

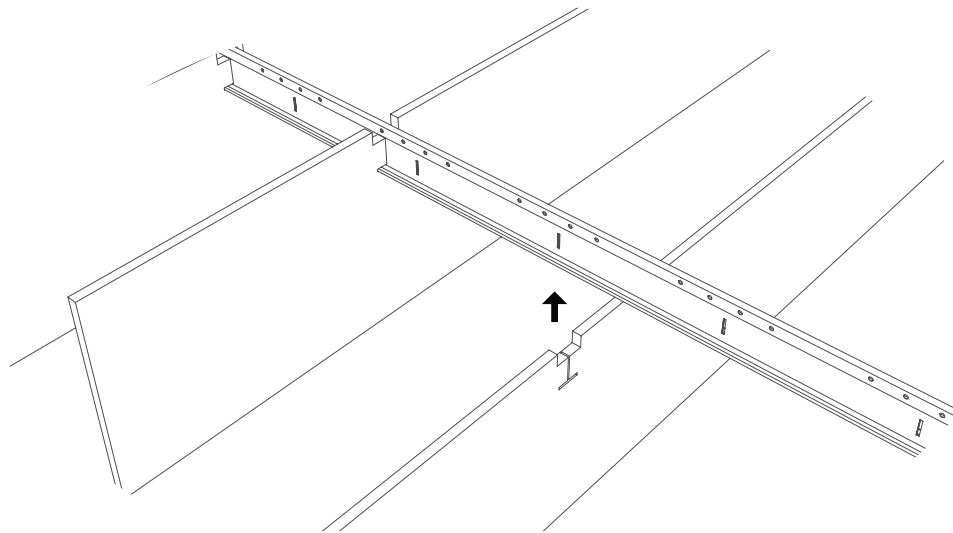

**Thank you for your order!**

For questions or concerns regarding your order or installation, please contact customer service via email at [customercare@ezobord.co.uk](mailto:customercare@ezobord.co.uk), or call us at 01843 666111 (International +44 1843 666111).

Visit our website at [shop.ezobord.com/uk](http://shop.ezobord.com/uk)

## ASSEMBLY INSTRUCTIONS

# BAFFLE CLOUD

- 7** Push the end baffles onto the end of the TBAR GRID.

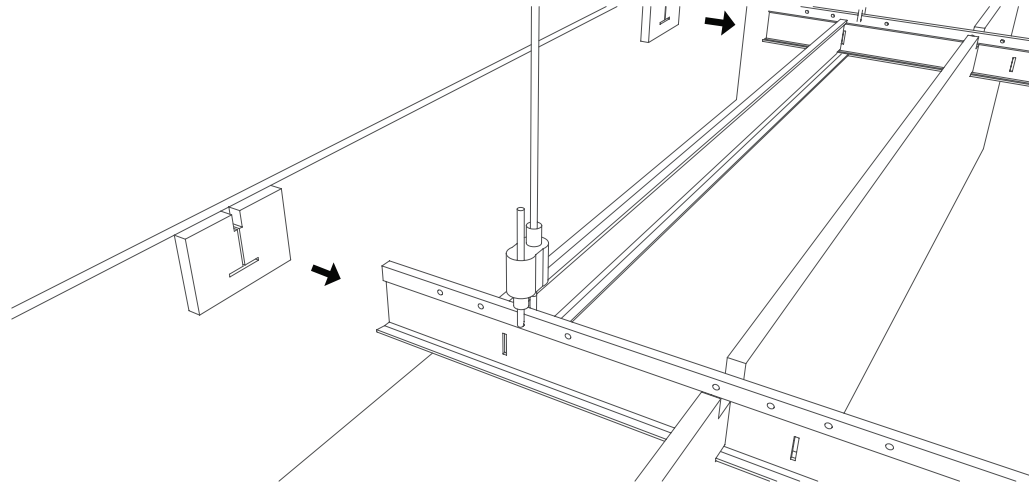

- 8** Push the SPACER into the cavity of BAFFLE, and hook the horizontal slot on the SPACER onto the horizontal part of the TBAR.

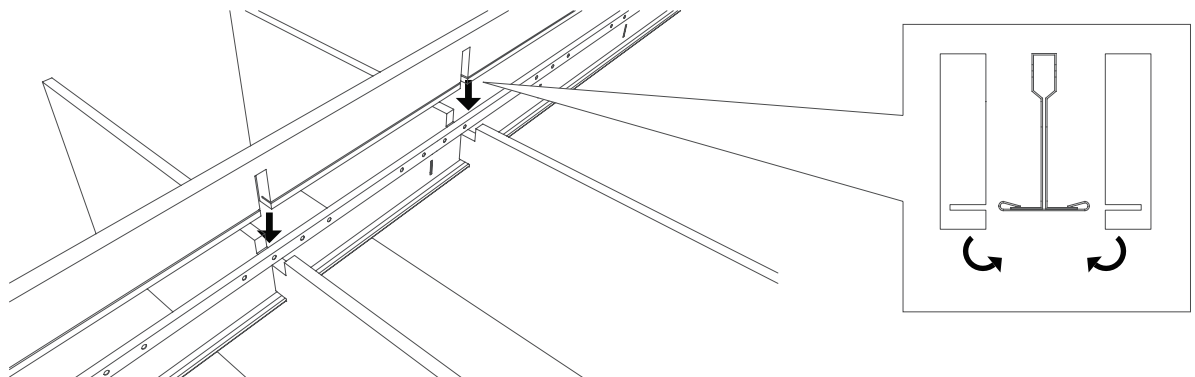

**Thank you for your order!**

For questions or concerns regarding your order or installation, please contact customer service via email at [customercare@ezobord.co.uk](mailto:customercare@ezobord.co.uk), or call us at 01843 666111 (International +44 1843 666111).

Visit our website at [shop.ezobord.com/uk](http://shop.ezobord.com/uk)

ASSEMBLY INSTRUCTIONS

# BAFFLE CLOUD

- 9** Use a knife cut off the material of the SPACER where there is the Cross TBAR.

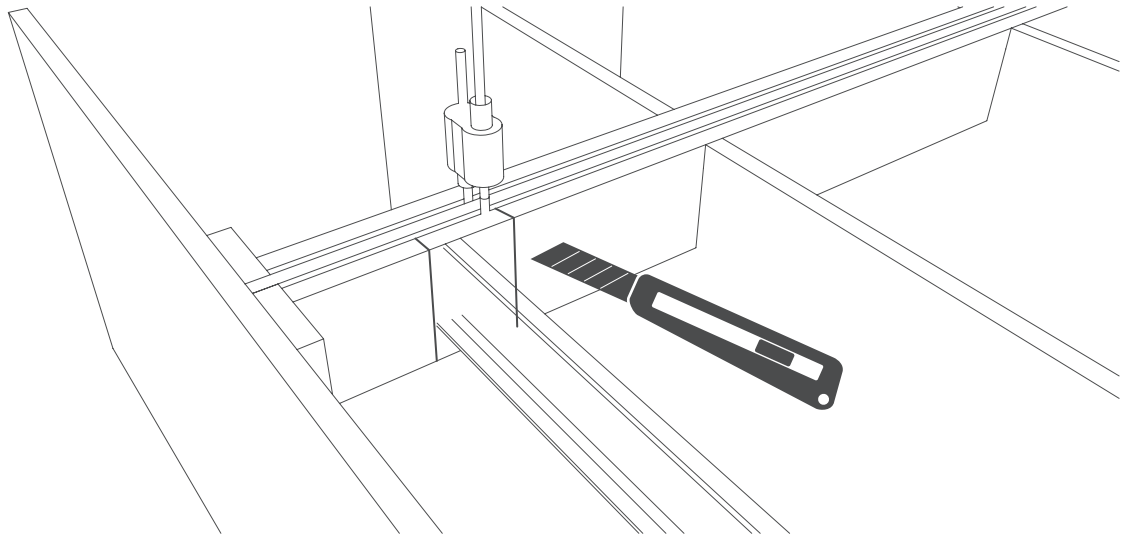

**Thank you for your order!**

For questions or concerns regarding your order or installation, please contact customer service via email at [customercare@ezobord.co.uk](mailto:customercare@ezobord.co.uk), or call us at 01843 666111 (International +44 1843 666111).

Visit our website at [shop.ezobord.com/uk](http://shop.ezobord.com/uk)